

**Use:**

Ventilation systems

**Assembly:**

In ventilation ducts, providing the following straight sections: 4x duct diameter before the damper and 1x duct diameter behind the damper

**Construction:**

Fitted with a shutter lever for adjustment of the opening diameter, and two tips allowing connection of air flow control.

The regulating lever is fitted with two bolts which fix the desired damper setting. Face edges finished with rubber seals allowing air tight fitting inducts.

**Material:**

Galvanized steel

**Type and dimension marking:**

**Products range:**

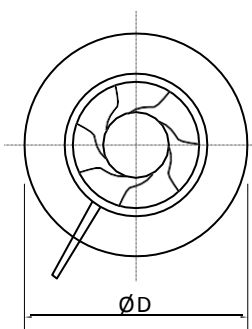

IRIS

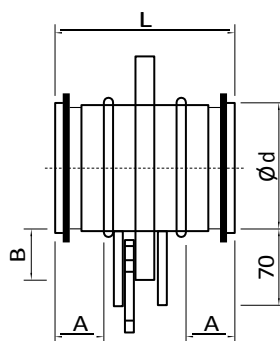

Typ	Ød [mm]	ØD [mm]	L [mm]	A [mm]	B [mm]
100	99	165	110	30	32
125	124	210	110	30	42
160	159	230	110	30	35
200	199	285	110	30	42
250	249	335	135	40	42
315	314	410	135	40	47
400	398	525	190	60	62

**Product marking:**

**IRIS-Ø200**

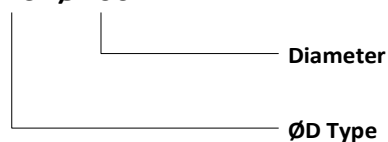

Diagrams for selection IRIS

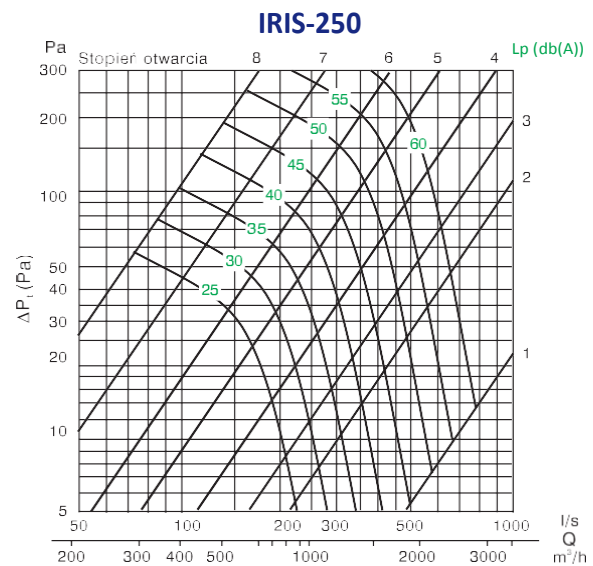
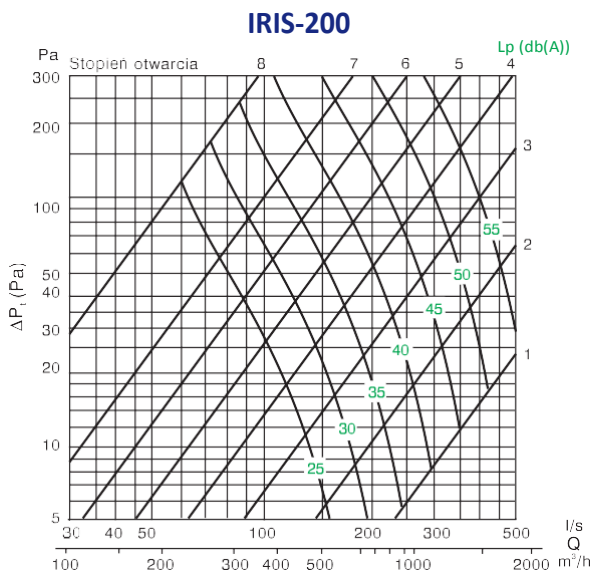
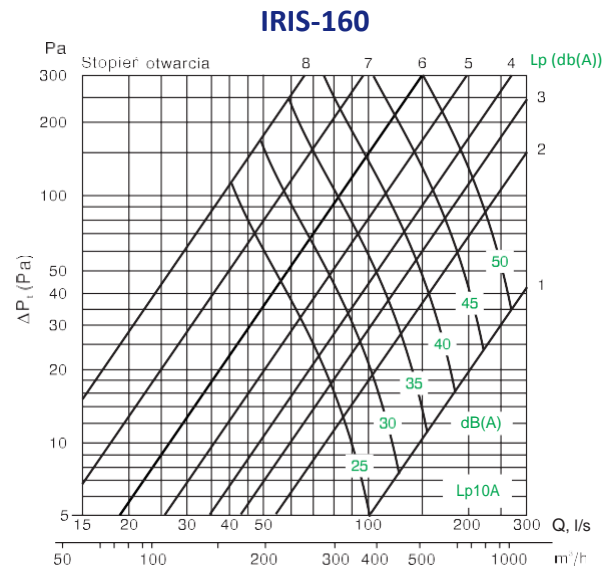
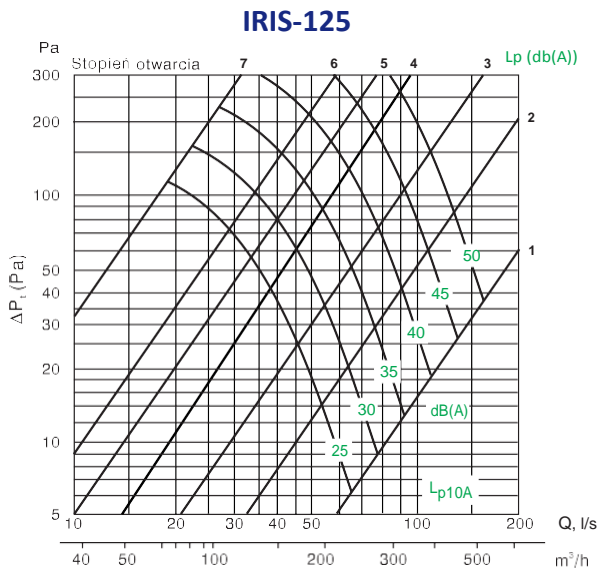
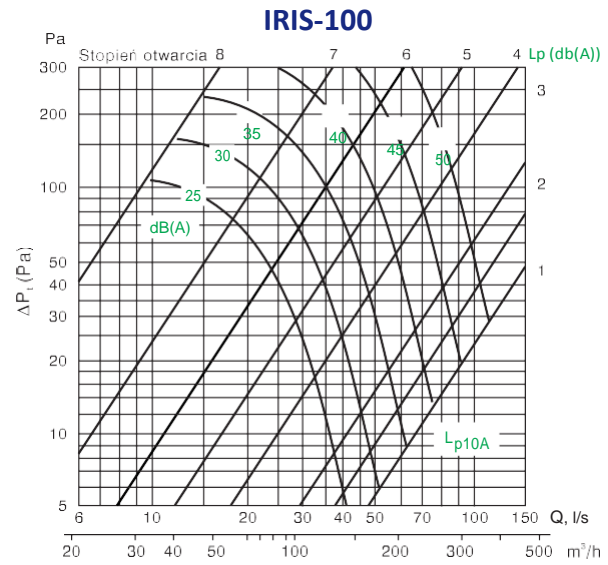
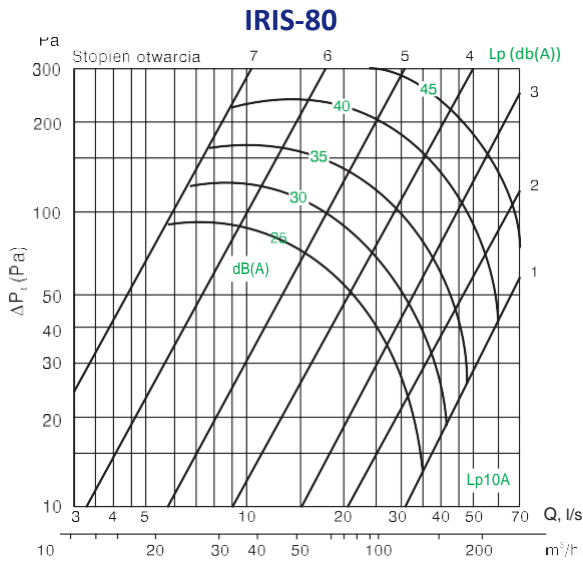

Diagrams for selection IRIS

