

**Use:**

Air supply or exhaust in low and medium pressure systems
Recommended for sanitary facilities for exhaust of used air or supply of fresh air.

Assembly:

On rectangular ducts in plenum boxes, in suspended ceilings and in walls. Fitted in an additional acid resistant steel fitting frame.

Construction:

Front frame and the disc baffle made of pressed acid resistant steel sheet elements. Front frame is foam insulated to provide air tight fitting aftermounting it with a fitting flange KM

Material:

Stainless steel.

Air flow regulation:

By the means of turning the disc baffle which has a regulating screw welded to the valve. Air flow regulation carried out from the front side without the necessity of dismantling the valve.

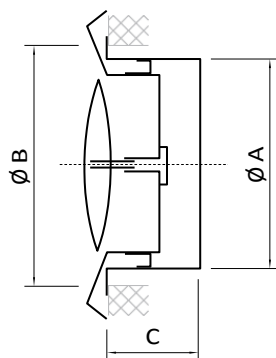
Type and dimension marking:**Products range:**

VS

Dimensions [mm]	ØA [mm]	ØB [mm]	C [mm]
100	97	118	52
125	120	141	52
150	145	162	52

Order's example:**VS-100**